



## Automotive Grade Multilayer Chip Ferrite High Current Beads

### Feature

Miniature volume.

No cross coupling between inductors due to low magnetic shield and high reliability.

No lead, ideal for high density SMT installation, with no directionality.

Superior solderability and resistance to soldering heat, suitable for reflow soldering.

Low DC resistance suitable for large current signals

### Application

Used in Class D amplifier circuits, the audio beads provide noise reduction while maintaining a good audio signal.

### Part Number

CBE 3225 A 681 T

Product Code	(L W T) Dimensions (mm)	Material Code	( ) Impedance	Packaging Style
--------------	----------------------------	---------------	------------------	-----------------

100505

CBE Automotive Grade  
Multilayer Chip Ferrite High  
Current Beads



Dimension

252010 (1008)	2.5± 0.20 (0.098± 0.008)	2.0± 0.20 (0.079± 0.008)	1.0± 0.20 (0.039± 0.008)	0.5± 0.3 (0.020± 0.012)
322515 (1210)	3.2± 0.20 (0.126± 0.008)	2.5± 0.20 (0.098± 0.008)	1.5± 0.20 (0.051± 0.008)	0.5± 0.3 (0.020± 0.012)

Electrical Characteristics

2520 Type

Part NO					
CBE252010A301T	± 25%	300	100	0.0300	4.0
CBE252010A601T	± 25%	600	100	0.0300	4.0

3225 Type

Part NO	

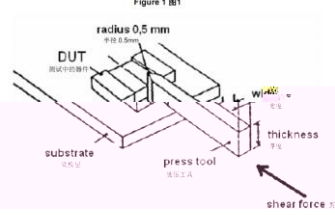

Temperature  
Cycling

	Solder ability	95% or more of electrode area shall be coated by new solder.	Solder bath; Lead-free solder; Temperature (245±5) ; Immersion timer (3±0.3) seconds.
	Board flex	$Z/Z \pm 30\%$ No Visible damage Impedance $Z/Z \pm 30\%$	The testing samples shall be mounted on a 100mm× 40mm FR4 PCB board which is 1.6mm± 0.2mm thick Bending shall be applied to the 2.0mm with 1.0mm/sec Duration 60± 5s
	Terminal Strength (SMD)	$Z/Z \pm 30\%$ No Visible damage Impedance $Z/Z \pm 30\%$	The testing samples shall be mounted on the testing epoxy boards exerting force on side of the samples, Size 1005: 5N ; Size 1608 17.7N Duration 60s± 1s 

Product Characteristic Curve

CBE252010 Type

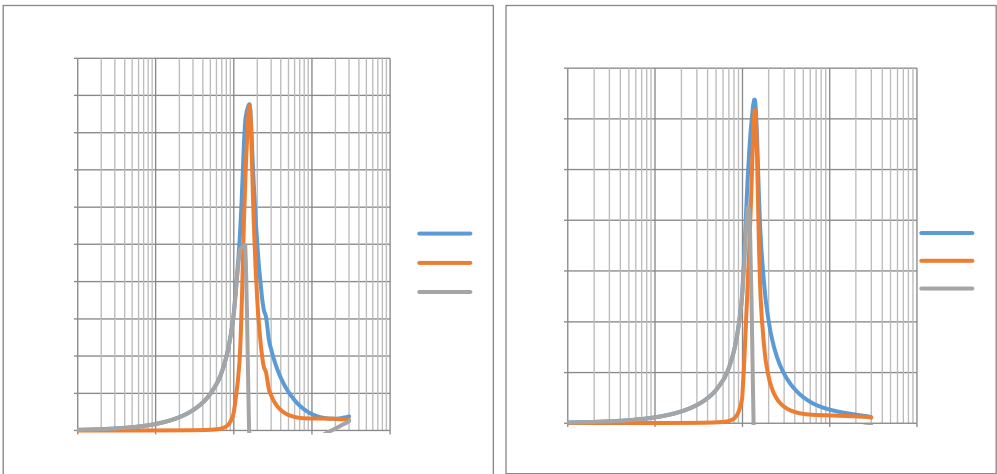

CBE322515 Type

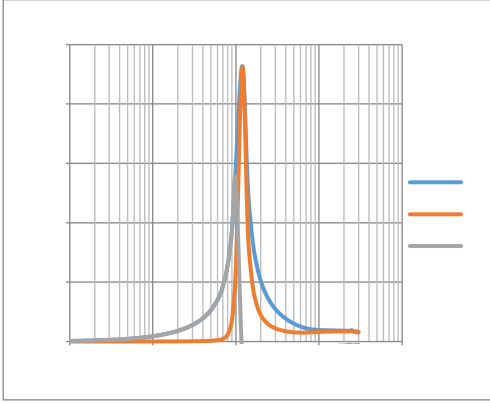

Packaging

\* Taping drawings

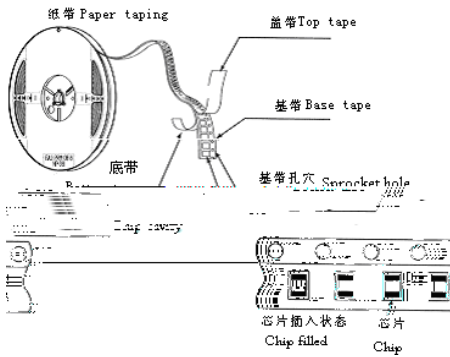

\* Reel dimensions (Unit: mm)

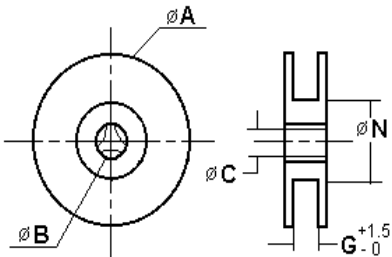

Size	A	B	C	N	G
CF-8	178±2.0	22.0±2.0	12.5±1.5	57±2.0	8

\* Leader and blank portion

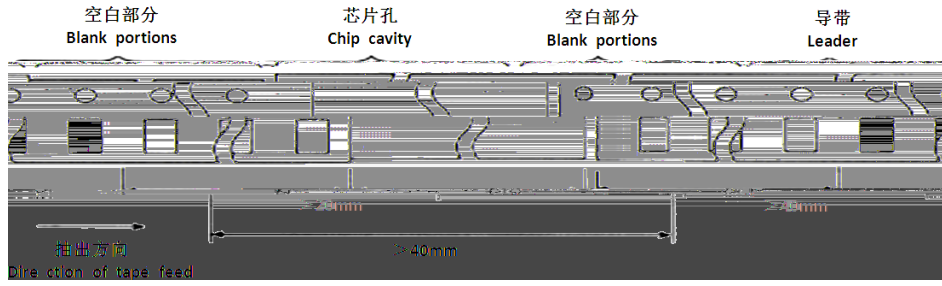

\* Taping dimensions (Unit: mm)

Paper tape

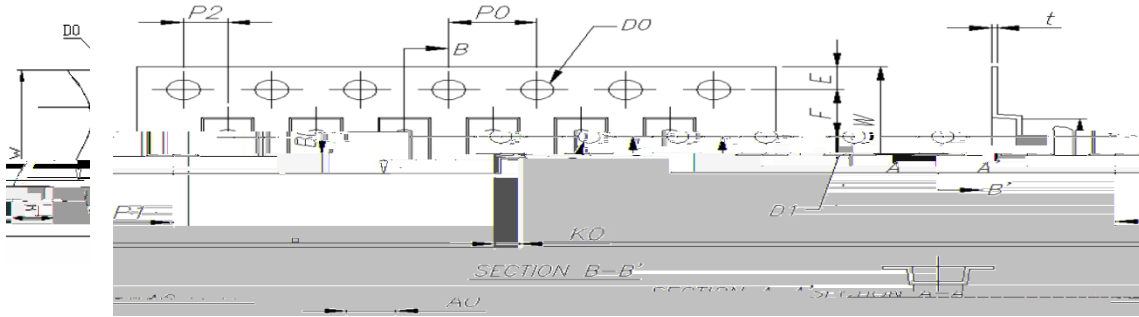

Part NO.	A0	B0	W	F	E	P1	P2	P0	D0	T
100505	0.65±0.1	1.15±0.1	8.0±0.2	3.5±0.1	1.75±0.2	2.0±0.1	2.0±0.1	4.0±0.2	1.55±0.1	0.60±0.1
160808	1.10±0.2	1.90±0.2	8.0±0.2	3.5±0.1	1.75±0.2	4.0±0.2	2.0±0.1	4.0±0.2	1.55±0.1	0.95±0.1
201209	1.50±0.2	2.30±0.2	8.0±0.2	3.5±0.1	1.75±0.2	4.0±0.2	2.0±0.1	4.0±0.2	1.55±0.1	0.95±0.1
321609	1.90±0.2	3.50±0.2	8.0±0.2	3.5±0.1	1.75±0.2	4.0±0.2	2.0±0.1	4.0±0.2	1.55±0.1	0.95±0.1

Embossed tape

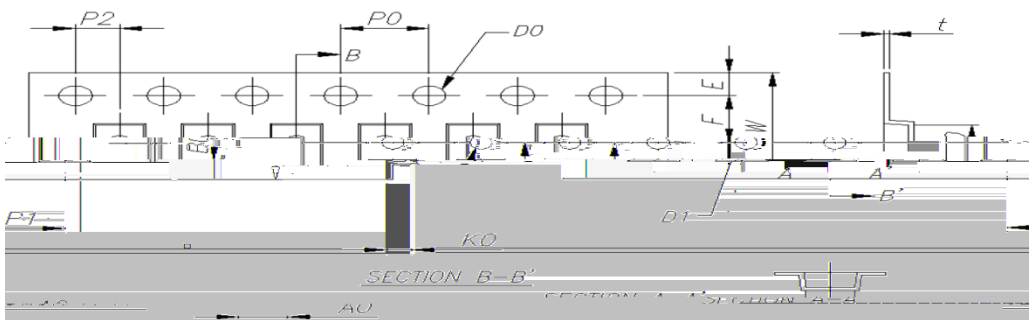

Size	453215	322513	321611	201212
W	12.00+/-0.20	8.00+/-0.20	8.00+/-0.20	8.00+/-0.2
E	1.75+/-0.10	1.75+/-0.10	1.75+/-0.10	1.75+/-0.10
F	5.50+/-0.10	3.50+/-0.10	3.50+/-0.10	3.50+/-0.10
D0	1.50+/-0.10	1.50+/-0.10	1.50+/-0.10	1.50+/-0.10
D1	1.50+/-0.10	1.00+/-0.10	1.00+/-0.10	1.00+/-0.10
P0	4.00+/-0.10	4.00+/-0.10	4.00+/-0.10	4.00+/-0.10



## MULTILAYER CHIP FERRITE BEADS

---

P010

40.0+/-0.20

40.0+/-0.20

40.0+/-0.20

40.0+/-0.20